

# CONCORD **SLIDER** FOR CONCORD NEO

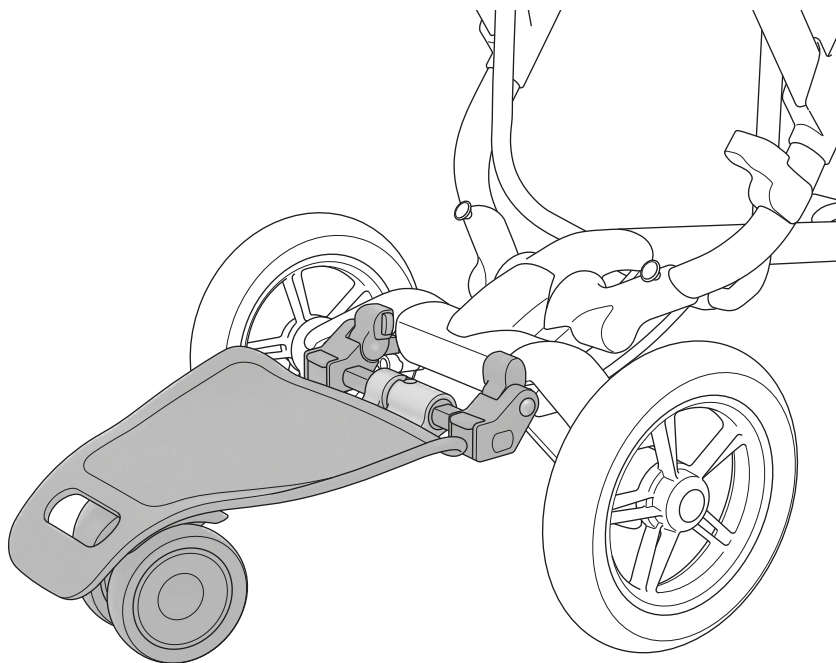

DEUTSCH	01
ENGLISH	09
FRANÇAIS	17
ESPAÑOL	25
ITALIANO	33
PORTUGUÊS	41
NEDERLANDS	49
NORSK	57
DANSK	65
SUOMI	73

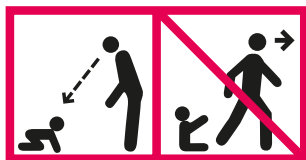

**Norm** DIN EN 1888:2012  
**standard** DIN EN 1888:2012  
**norme** DIN EN 1888:2012  
**norma** DIN EN 1888:2012  
**szabvány** DIN EN 1888:2012

## **\_ ENGLISH**

OVERVIEW	10
NOTE	10
WARNINGS	11
CLEANING AND MAINTENANCE	12
INSTALLATION OF THE CONCORD SLIDER	13
STORING THE CONCORD SLIDER ON THE BUGGY	14
REMOVAL OF THE CONCORD SLIDER	15
GUARANTEE	16

## **\_ THANK YOU!**

Thank you for purchasing a quality product from CONCORD.  
You will be impressed by the versatility and safety of this product.  
We hope that you will enjoy using your new CONCORD SLIDER.

## \_ OVERVIEW

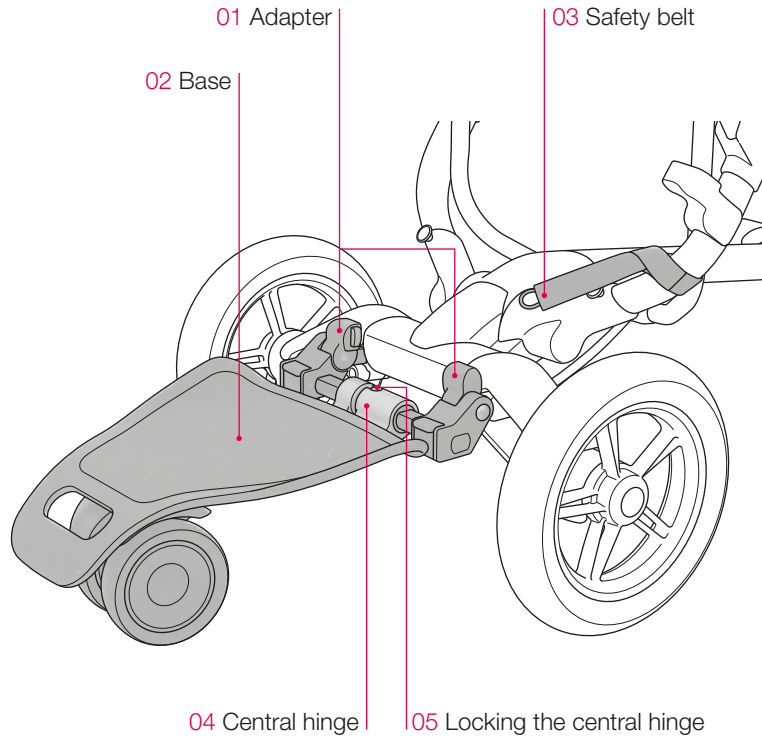

## \_ NOTE

In order to ensure that the child is standing comfortably, it is necessary to incline the seat unit of the CONCORD NEO upwards, or adjust the handle in an appropriate position.

## \_ WARNINGS

### IMPORTANT

- Read these instructions carefully before use and keep them for future reference. Your child's safety may be affected if you do not follow these instructions.
- IMPORTANT - Keep these instructions for future reference.

### WARNING!

- Never leave your child unattended.
- Only use the CONCORD SLIDER in combination with the CONCORD NEO.
- Ensure that all the locking devices are engaged before use.
- Only one child must stand on the CONCORD SLIDER at one time.
- The maximum load capacity of the CONCORD SLIDER is 20 kg.
- The CONCORD SLIDER is only suitable for children who can already stand up and walk.
- Always make sure that the child holds on tight when using the CONCORD SLIDER.
- Explain to the child that the CONCORD SLIDER is not a toy. Make sure that the children never install or remove the CONCORD SLIDER themselves.
- Do not let your child play with this product.
- Before travelling up steps or a steep incline, always take your child out of the CONCORD SLIDER.
- Keep the child away from the moving parts when these are being operated by a responsible adult.
- The parking device shall be engaged when placing and removing the children.
- Any load attached to the handle and/or on the back of the backrest and/or on the sides of the vehicle will affect the stability of the vehicle.
- This product is not suitable for running or skating.
- To avoid injury ensure that your child is kept away when unfolding and folding this product.

- Check all the parts of the CONCORD SLIDER, and the accessories used, at regular intervals.
- Never use accessories that have not been approved by CONCORD.
- Only replacement parts supplied or recommended by CONCORD shall be used.
- The guarantee does not apply if the CONCORD SLIDER is damaged through excess strain, incorrect usage or the use of other spare parts / accessories.
- Throw away all plastic packaging immediately. It can put your child's life at risk.

Non-compliance with the instructions in this manual may affect the safety of your child!

## \_ CLEANING AND MAINTENANCE

To prevent corrosion, always keep the metal parts of the CONCORD SLIDER clean and dry. Use silicone spray to regularly lubricate the moving parts. Do not use oil or grease.

Only clean parts made from synthetic materials using lukewarm water and a mild cleaning agent. Coarse contamination can be brushed off when dry.

## \_ INSTALLING THE CONCORD SLIDER

The CONCORD SLIDER must only be attached using the receptacle provided in the centre of the CONCORD NEO. Installation at another position or manner is not permitted.

From the rear, place the adapter (01) on the base (02) of the receptacle on the CONCORD NEO and press the CONCORD SLIDER forwards until it engages, audibly and visibly detectable.

The unlocking buttons of the adapter (01) must audibly engage and disengage.

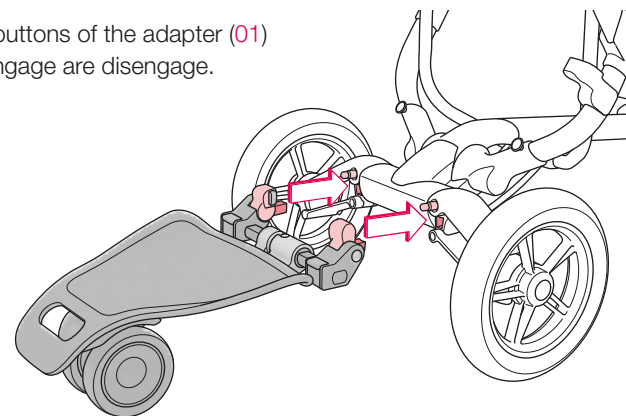

Before each journey, check to make sure that installation has been carried out correctly, the locking mechanism is closed and that the central hinge (05) is locked.

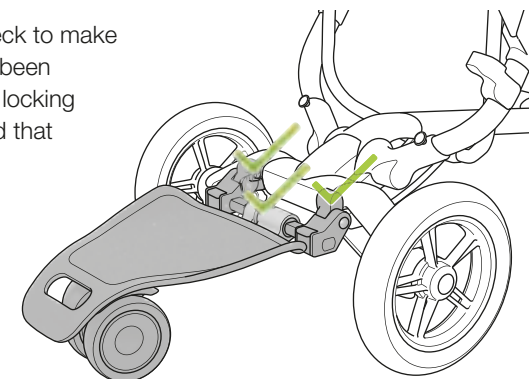

## \_ STORE THE CONCORD SLIDER ON THE BUGGY

The CONCORD SLIDER can be folded up when no child is to be transported on it. For this, press the button on the underside of the central hinge (04) upwards and first push the base (02) to the right and subsequently rotate upwards.

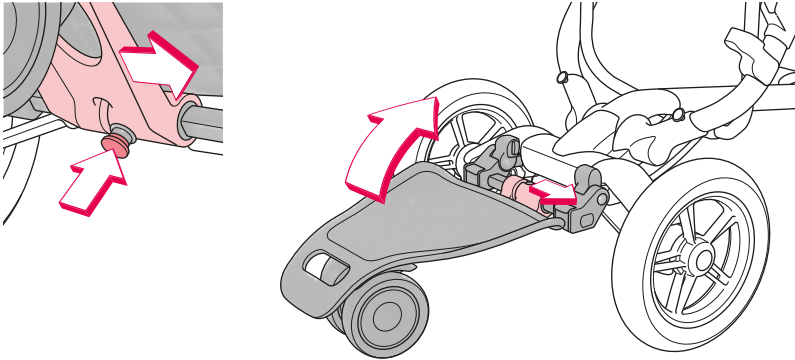

Attach the CONCORD SLIDER using the safety belt (03) previously attached to the CONCORD NEO.

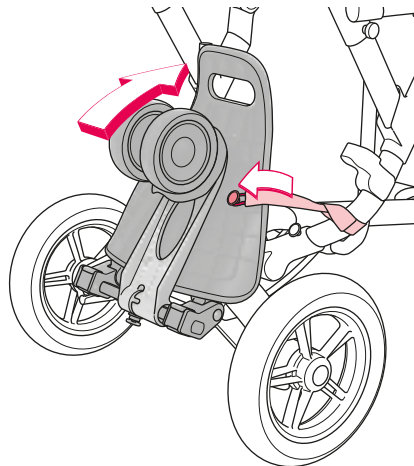

To fold down the CONCORD SLIDER, firmly hold the base (02) and release the safety belt (03).

Fold down the CONCORD SLIDER and subsequently move the central hinge (04) upwards and to the left until the locking (05) on the central hinge audibly and firmly engages.

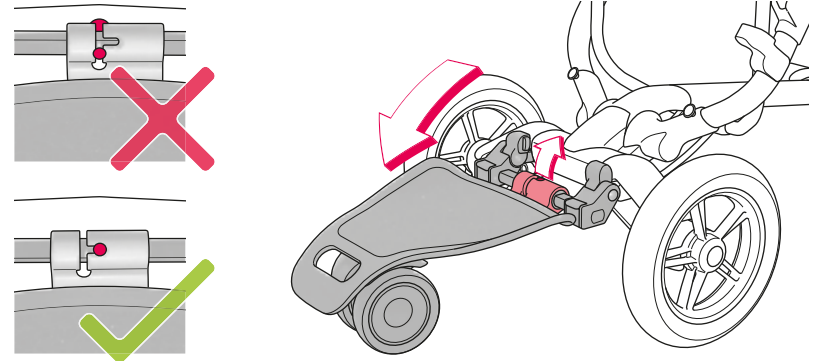

## \_ REMOVAL OF THE CONCORD SLIDER

Press the unlocking buttons on both adapters (01) of the CONCORD SLIDER and remove the CONCORD SLIDER from the receptacle of the CONCORD NEO to the rear.

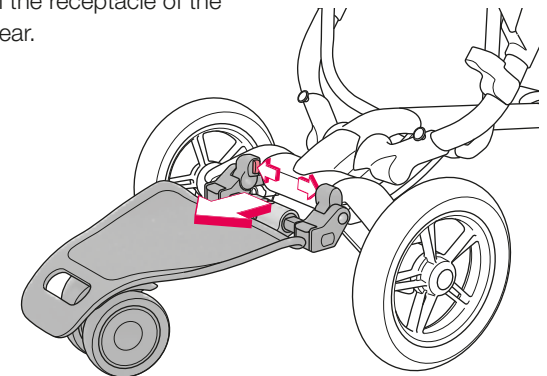

## **\_ GUARANTEE**

The guarantee begins on the day of purchase. The guarantee period corresponds to the statutory warranty period in the end-user's country concerned. At the manufacturer's discretion, the guarantee shall cover rectification, replacement or a price reduction.

The guarantee is valid for the original purchaser only. In the event of any defect, claims can not be considered unless the specialist dealer is notified of the fault as soon as it occurs for the first time. If the specialist dealer is unable to remedy the problem himself, he must return the product to the manufacturers together with details of the complaint, official proof of purchase and the purchase date. The manufacturers assume no liability for faulty goods that they did not supply.

The guarantee does not apply where:

- the product has been modified;
- the product is not brought back to the specialist dealer complete with proof of purchase within 14 days of the defect occurring;
- the defect was caused by improper usage or maintenance or due to anything else deemed to be the fault of the user, in particular failure to comply with the instructions for use;
- repairs have been carried out on the product by third parties;
- the defect was caused as the result of an accident.
- the serial number has been damaged or removed

The guarantee makes no provision for any alteration or deterioration to the product that is incurred through normal usage (wear and tear). The period of guarantee shall not be extended by any remedial measures carried out by the manufacturers in the event of a claim.

\_ **DEUTSCH**  
\_ **ENGLISH**  
\_ **FRANÇAIS**  
\_ **ESPAÑOL**  
\_ **ITALIANO**  
\_ **PORTUGUÊS**  
\_ **NEDERLANDS**  
\_ **NORSK**  
\_ **DANSK**  
\_ **SUOMI**

Einbau- und Bedienungsanleitung  
Instructions for attachment and use  
Directives d'installation et mode d'emploi  
Instrucciones de montaje y de uso  
Istruzioni per l'uso e il montaggio  
Manual de montagem e de utilização  
Inbouw- en bedieningshandleiding  
Bruksanvisning og monteringsveiledning  
Monterings- og betjeningsvejledning  
Kiinnitys- ja käyttöohjeet

**CONCORD** GmbH  
Industriestraße 25  
95346 Stadtsteinach  
Germany

Phone +49 (0)9225.9550-0  
Fax +49 (0)9225.9550-55  
info@concord.de

www.concord.de



SL 05/0414 // IM01693-00